

PRINT THIS PAGE AT 100% SIZE WITHOUT SCALING

Front

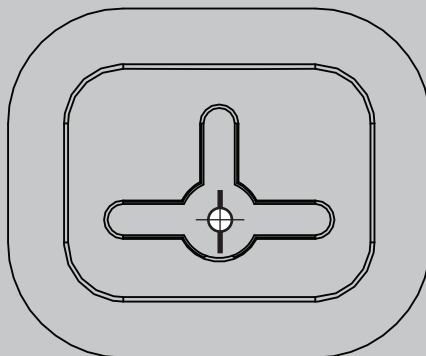

Drill template for wall-mounting the FortiVoice system

1. Tape the template to the wall in the desired orientation.
2. Mark the position of the drill holes.
3. Drill pilot holes. If you're mounting on drywall, plasterboard or gyprock, the holes should accommodate the anchors.
4. If you're using anchors, insert them.
5. Insert screws, leaving about 1/8 inch protruding from the wall.
6. Place the FortiVoice system key holes over the screws and slide into position.

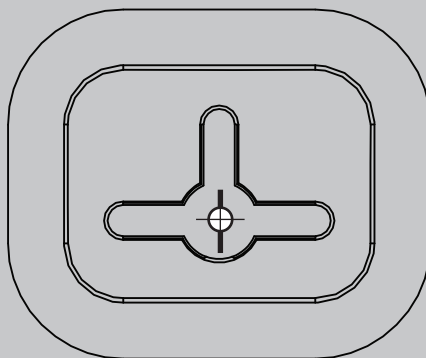

Rear